

brand **AUCHAN**

date

JAN/02

SHEET 1/2

Model

T 1700 3V debrayage de lam

Product number

9538762-29

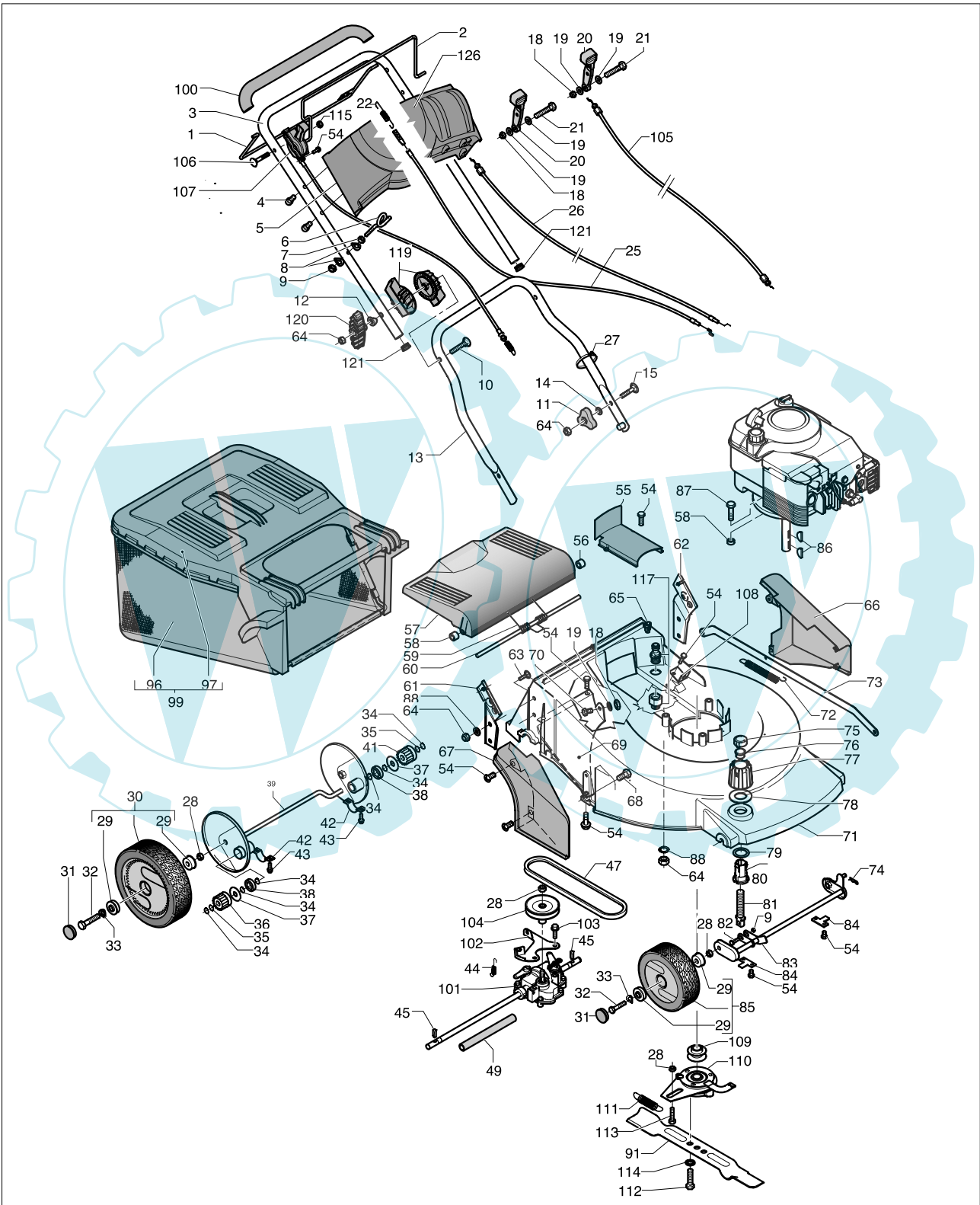

brand	AUCHAN
-------	---------------

date	JAN/02	SHEET 2/2
------	--------	-----------

T 1700 3V debrayage de lame

Pos	PN ELX	PN MEP	Q.ty	Note	Pos	PN ELX	PN MEP	Q.ty	Note
1	531205789	10 1407 63	1		63	531205741	10 1403 10	4	TTSQ M 8x16
2	531205788	10 1407 53	1		64	531207982	20 1063 00	9	M 8
3	531205837	10 1412 23	1		65	531205153	10 1213 53	1	
4	531208844	20 7349 00	4	TCTC 2F Ø 5x16	66	531205747	10 1403 33	1	SINISTRO
5	531210959	10 1754 92	1		67	531205743	10 1403 23	1	DESTRO
6	531205169	10 1214 70	1		68	531205740	10 1402 90	4	TCTC 2F Ø 4x12
7	531207165	10 5012 00	1	M6	69	531205734	10 1402 50	1	
8	531204961	10 1159 00	2	Ø 6,5	70	531207838	10 8303 00	1	TE M 5x16
9	531208491	20 2818 00	3	M 6 NYLON	71	531205803	10 1409 2E	1	
10	531205842	10 1412 70	2	TTSQ M 8x75	72	531205715	10 1400 90	1	
11	531204923	10 1143 03	2	M 8	73	531205736	10 1402 63	1	
12	531205841	10 1412 63	2		74	531206653	10 2814 00	2	
13	531205836	10 1412 13	1		75	531205720	10 1401 13	1	
14	531204922	10 1142 00	2	Ø 8,5	76	531205726	10 1401 47	1	
15	531204921	10 1141 00	2	TTSQ M 8x25	77	531205717	10 1401 03	1	
18	531208492	20 2821 00	3	M 5 NYLON	78	531205738	10 1402 70	1	
19	531206666	10 2847 00	5	Ø 5/15/1,5	79	531205739	10 1402 80	1	
20	531205139	10 1212 63	2		80	531205724	10 1401 37	1	
21	531207836	10 8300 00	2	TE M 5x25	81	531205723	10 1401 27	1	
22	531205215	10 1219 10	1		82	531208425	20 2287 05	1	TE M 6x35
25	531211251	10 1416 10	1		83	531205706	10 1400 33	1	
26	531211147	10 1415 60	1	3V X PL'01	84	531205536	10 1352 70	2	
27	531205581	10 1356 00	2		85	531204607	09 1412 84	2	Ø 170/26 AUTO
28	531207978	20 1017 00	6	M 10	86	531204907	10 1009 00	2	DIN 6888 4x6,5
29	531205214	10 1219 00	8		87	531205768	10 4078 00	2	B&S XTL60
30	531204609	09 1412 94	2	Ø 210/26 AUTO	87	531205768	10 1404 20	1	TE M8X65 TE M8X90
31	531210789	10 1727 23	4		88	531207981	20 1062 00	7	Ø 8E
32	531205042	10 1200 90	4		91	531205796	10 1408 50	1	cm.53
33	531206644	10 2751 00	4	DIN 137 B 13x1	96	531208260	20 1403 74	1	GRIGIO
34	531208772	20 6558 00	6	Ø 12	97	531205762	10 1403 92	1	
35	531208859	20 7613 00	2	Ø 12/17/0,3	99	531204610	09 1413 82	1	
36	531205859	10 1413 90	1	DESTRO/T.	100	531205812	10 1409 33	1	
37	531207847	10 8312 00	2	Ø 12/34/0,7	101	531207700	10 7681 00	1	FORI Ø 4,85
38	531208778	20 6576 00	2	6001/2RS Ø 12/28/8	102	531205774	10 1405 70	1	
39	531205705	10 1400 23	1		103	531205787	10 1407 20	2	TRILOBATA TEFR M8x16
41	531205860	10 1414 00	1	SINISTRO/T.	104	531205776	10 1406 00	1	
42	531206652	10 2812 00	2		105	531211141	10 1415 60	1	
43	531207385	10 6028 00	4	TRILOBATA Ø 5x12	106	531207776	10 8037 00	1	TTSQ M6x50
44	531205216	10 1219 20	1		107	531205792	10 1408 10	1	
45	531205786	10 1407 10	2	Ø 4,75 x 18,55	108	531205795	10 1408 40	1	
47	531206701	10 2949 00	1	Z 32 (10x800Li)	109	531205797	10 1408 60	1	
49	531207697	10 7665 03	1	mm 275	110	531204571	09 1408 20	1	
54	531207856	10 8318 00	15	TRILOBATA Ø 5x10	111	531205799	10 1408 80	1	
55	531205772	10 1405 43	1		112	531207176	10 5013 20	1	TE M10X25 UNI 5739 - 8.8
56	531205733	10 1402 23	1	H15	113	531205800	10 1408 90	1	TE M10X45 UNI 5737 - 8.8
57	531205486	10 1350 72	1		114	531208974	30 1021 00	2	Ø 10E
58	531205732	10 1402 13	4	H5	115	531208063	20 1227 90	1	TEFR M6 FLANGIATO
59	531206180	10 1551 90	1		117	531205848	10 1413 13	1	
60	531205731	10 1401 90	1		119	531205839	10 1412 43	1	
61	531205728	10 1401 63	1	DESTRO	120	531205840	10 1412 53	1	
62	531205730	10 1401 73	1	SINISTRO	121	531208950	20 8333 03	1	
					126	531210950	10 1754 32	1	

